

CA-HM-UNI-EVO.008

UNIVERSAL 2-DIN INSTALLATION KIT



EN - Installation Manual

Tools required (not included)

- Phillips Screwdriver
- 4 mm Allen Head Screwdriver
- Washer or Belt / Nut Combination

Kit components



Please note

For steps 2 and 6, reference to the installation manual provided with the radio for which hardware to use. The display screen and radio chassis use two different types of screws.

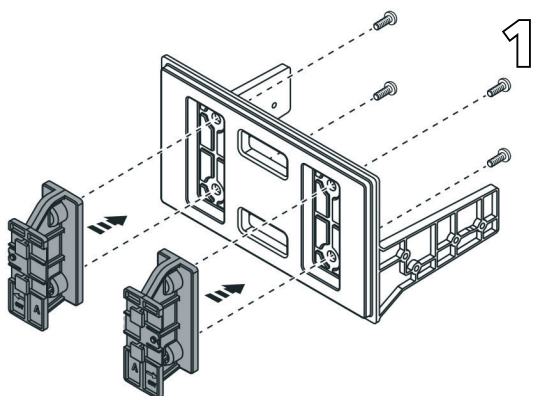
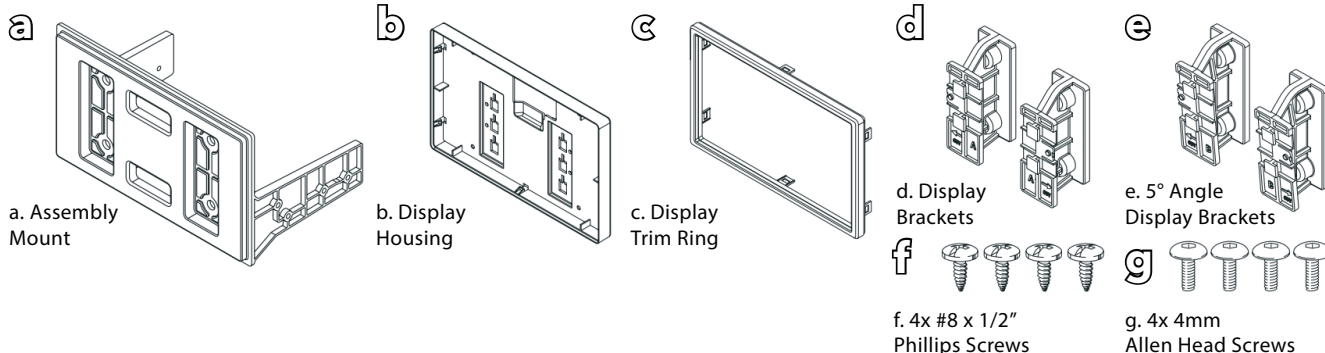

Secure the display brackets to the assembly mount using (4) Allen head screws provided. **Note:** The brackets have a locking pin on them which must face outwards.

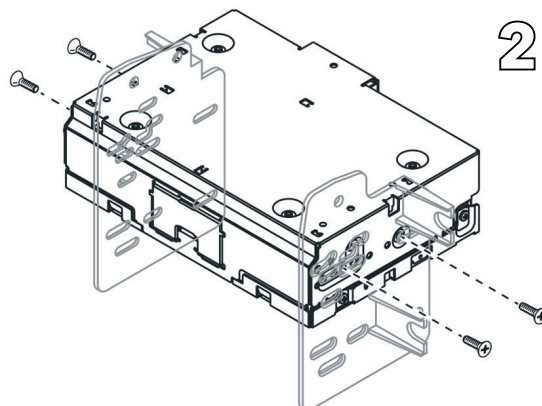

Secure the radio chassis to the brackets of your 2-DIN kit using (4) screws supplied with the radio.

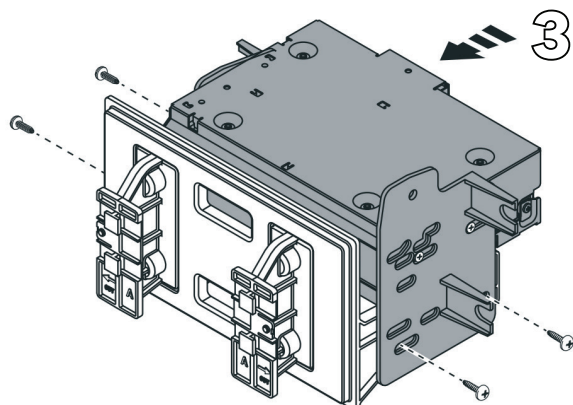

Secure the assembly mount to the brackets of your 2-DIN kit using (4) Phillips screws provided. Route the RGB display cable from the radio chassis, through the opening in the assembly mount.



Optional extension cable CD-RGB150E available if required.

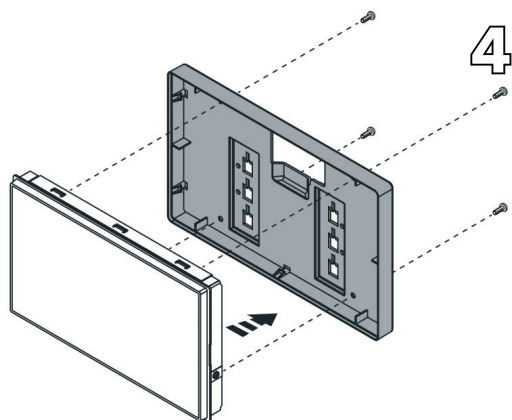

Secure the radio display to the display housing using (4) screws supplied with the radio.

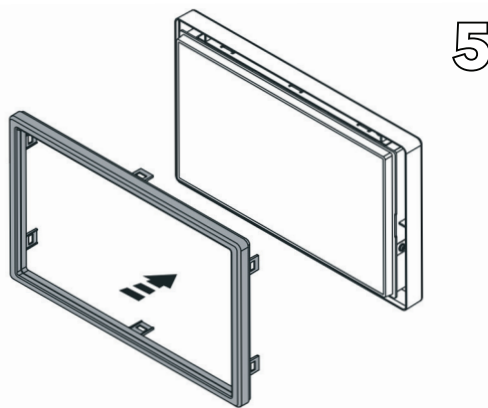

Clip the display trim ring onto the assembly.

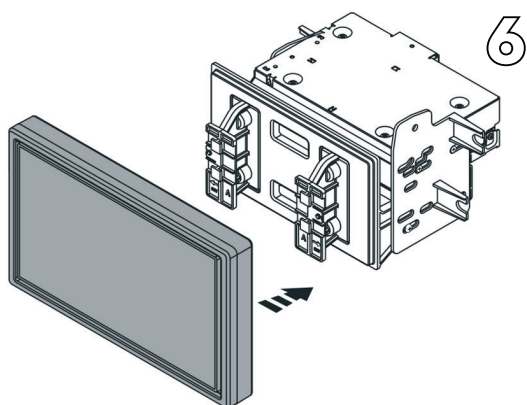

Plug the RGB display cable into the display, then slide and lock in place the display housing to the display brackets. Note: The locking pins can be pulled back to release the display housing.